

# Driver-Free Wireless Presentation System

# InstaShow® WDC25/VS25 Button Kit



- Compatible with VS25 Receiver  
(The button kit must be used with a receiver.)
- Plug-and-Play Button without Apps and Drivers
- Support Resolutions up to 4K@60fps
- Type-C and HDMI swappable design with U-magnet bolt
- Quick switch from presentation mode to video mode at the click of a side button



## Launch Wireless Conferencing Instantly

Compatible with InstaShow® WDC25 & VS25, the Button enables instant plug-and-play wireless presentations—no apps, drivers, or network setup required.



## Versatile Connection Design

Quickly switch between HDMI and Type-C for easy maintenance and seamless device use.

## Specifications

### Button

|                |                       |
|----------------|-----------------------|
| Connector Type | USB Type C (Default)* |
| Function Key   | Split Screen Key      |

\*Switchable between Type C and HDMI

### Button Package

|             |     |
|-------------|-----|
| Button      | (1) |
| HDMI Cable* | (1) |

### Dimensions & Connectivity

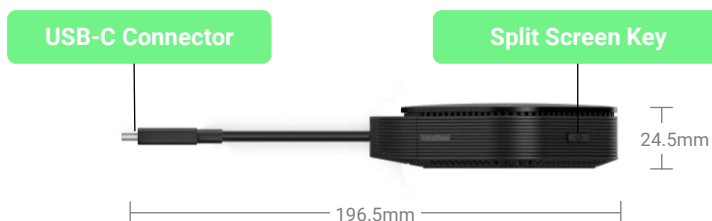
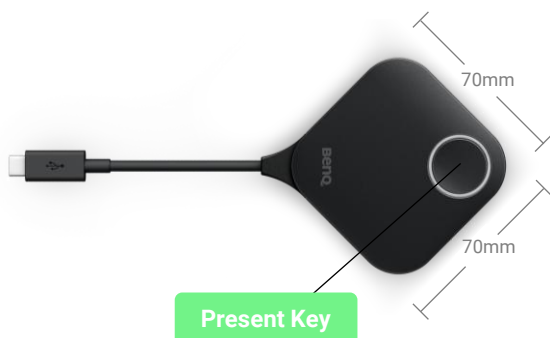

[benq.eu/en-eu/business/wireless-presentation/instashow-wireless-collaboration.html](https://benq.eu/en-eu/business/wireless-presentation/instashow-wireless-collaboration.html)

